

US WHEELER

HANGZHOU WHEELER GENERAL MACHINERY INCORPORATED CO.,LTD

Add:
NO.288 Shunfeng Road,Linping District

Tel:
+86 571 8369 5216

Fax:
+86 571 8369 5836

E mail:
info@wheeler-us.com

400 780 1898
24/7 Service Hotline.

Machine Tool Lifetime Service

We provide on-call service 24/7. If you encounter any equipment maintenance and repair problems, please contact us. If you have any suggestions, please log in to the company's official website to leave a message.

www.wheeler-us.com



Sample parameters and information are subject to change without prior notice, and the final data is subject to the technical agreement.
HL-WZ2411-01-1000



For more information
please follow the
Official WeChat account

Five-axis Series High-speed processing center



US WHEELER

INDUSTRIAL ROBOT/
CNC MACHINETOOLS/
SMART FACTORY

ABOUT US

Hangzhou Wheeler Intelligent General Machinery Incorporated Co.,Ltd is a national high-tech enterprise focusing on CNC machining equipment, machine tool loading and unloading automation, digital factories, and non-standard fixture design and manufacturing. The company was established in January 2015, and its operation center is located in Linping Economic Development Zone, Hangzhou. The company currently has more than 300 employees and an efficient professional technical R&D team, including more than 60 professional and technical personnel with various intermediate and senior technical titles (engineers). The company has a 5,000 square meter R&D center and a 43,000 square meter production and debugging base, and owns more than 50 patent technologies. It has offices and after-sales service outlets in Shanghai, Jiangsu, Anhui, Shandong, Henan, Jilin, Chongqing, Ningbo, Taizhou, Wuhan, Xi'an, Zhengzhou, etc. The company's products are exported to Turkey, Egypt, South Africa, Brazil, Australia, Singapore, Malaysia, Thailand and other countries.

Our
Certification



The company's main products include machining equipment, machine tool loading and unloading robots, machine tool fixtures, peripheral automated logistics equipment, and robot integration systems. It is a strategic partner of robot companies such as Germany's KUKA and Switzerland's ABB. It provides customers with mechanical processing automation technology solutions, a full set of automation equipment, technical consulting, and comprehensive after-sales and technical services. The products are widely used in mass production industries such as automotive parts processing and engineering machinery



BASIC INFORMATION

Five-axis series High Speed Machining Center

The design of this series of machine tools is optimized through advanced finite element analysis. The overall structure has strong rigidity, high precision retention and stability. The main parts of the machine tools, such as the bed, column, saddle, worktable and spindle box, are made of high-quality gray cast iron with high seismic resistance. They are cast in metal molds and treated with special processes to improve the mechanical properties of the materials.



+ Sample Display



+ Impeller



+ Caliper



+ Wheel Hub

+ Scope of Application

The five-axis high-speed machining center is suitable for processing various milling parts and complex curved surface parts, completing milling, drilling, boring, reaming, tapping and other multi-process processing. The machine tool has high rigidity and high precision, and has good thermal stability, long-term precision retention and excellent shock absorption. It is widely used in parts and mold processing in the automotive and motorcycle parts, molds, ships, and other industries. The five axis CNC rotary table can expand the processing of multi-angle parts and gear and cam parts..



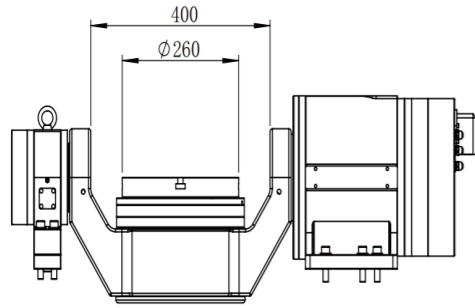

Rotary Table

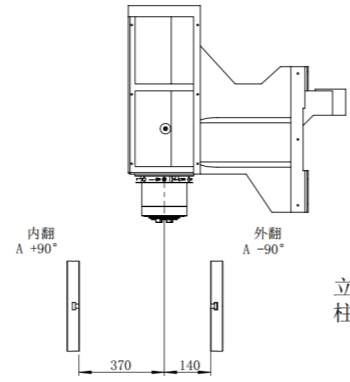

Interference Diagram

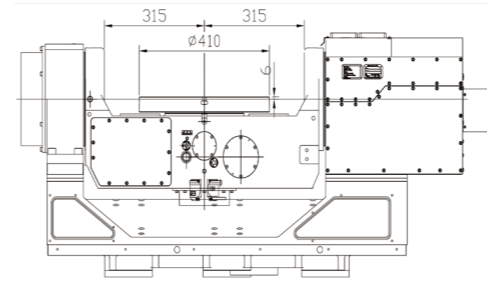

Rotary Table

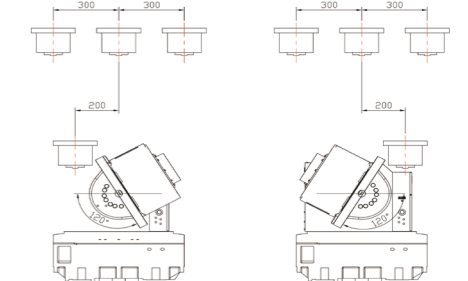

Interference Diagram

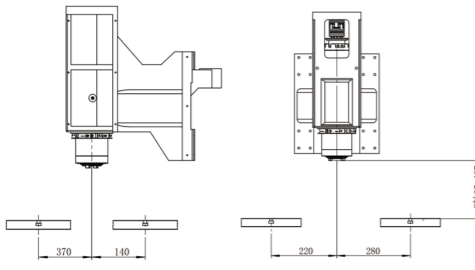

Processing Range

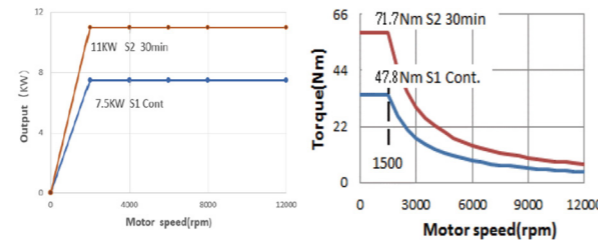

Spindle power&torque Diagram

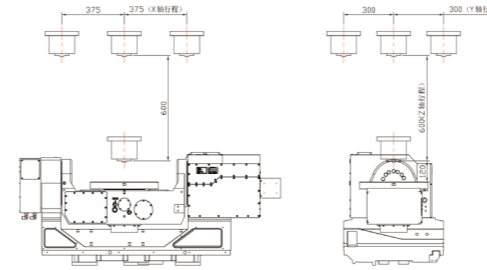

Processing Range

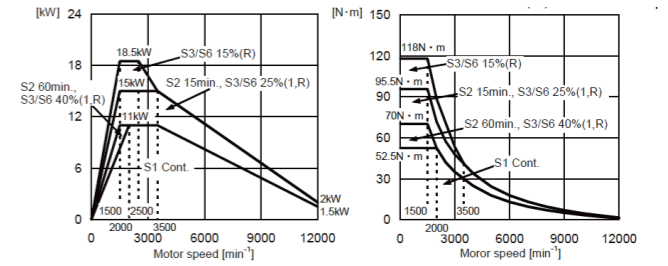

Spindle power&torque Diagram

EU5-380

EU5-700

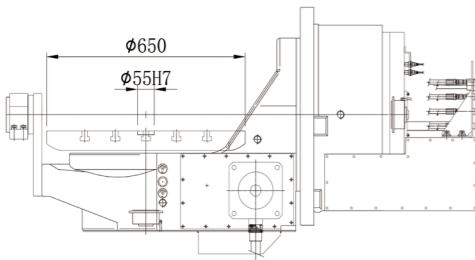

Rotary Table

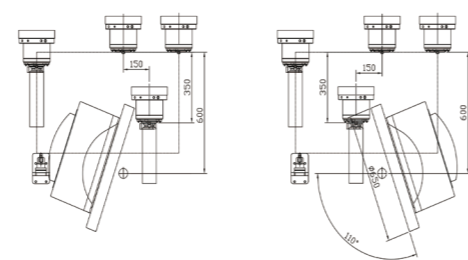

Interference Diagram

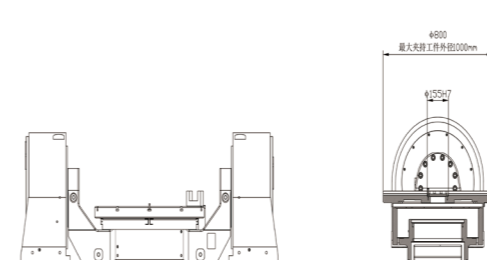

Rotary Table

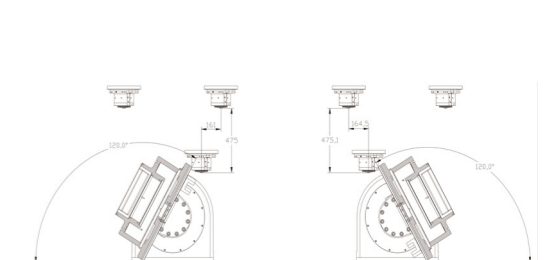

Interference Diagram

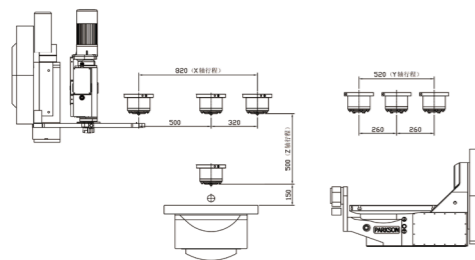

Processing Range

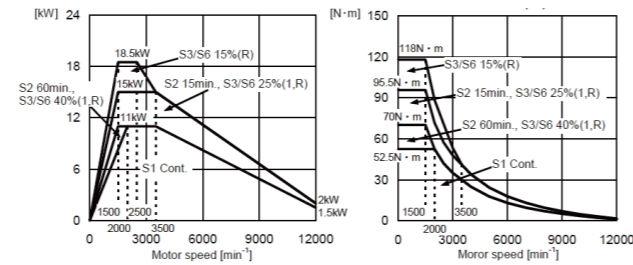

Spindle power&torque Diagram

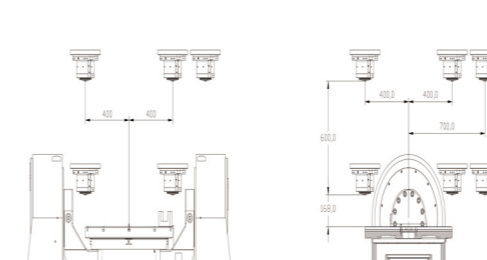

Processing Range

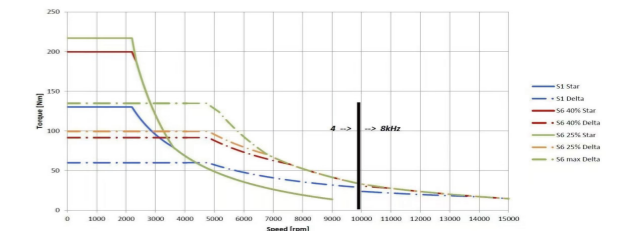

Spindle power&torque Diagram

EU5-650

EU5-800

DIAMETER

+ EU5-380

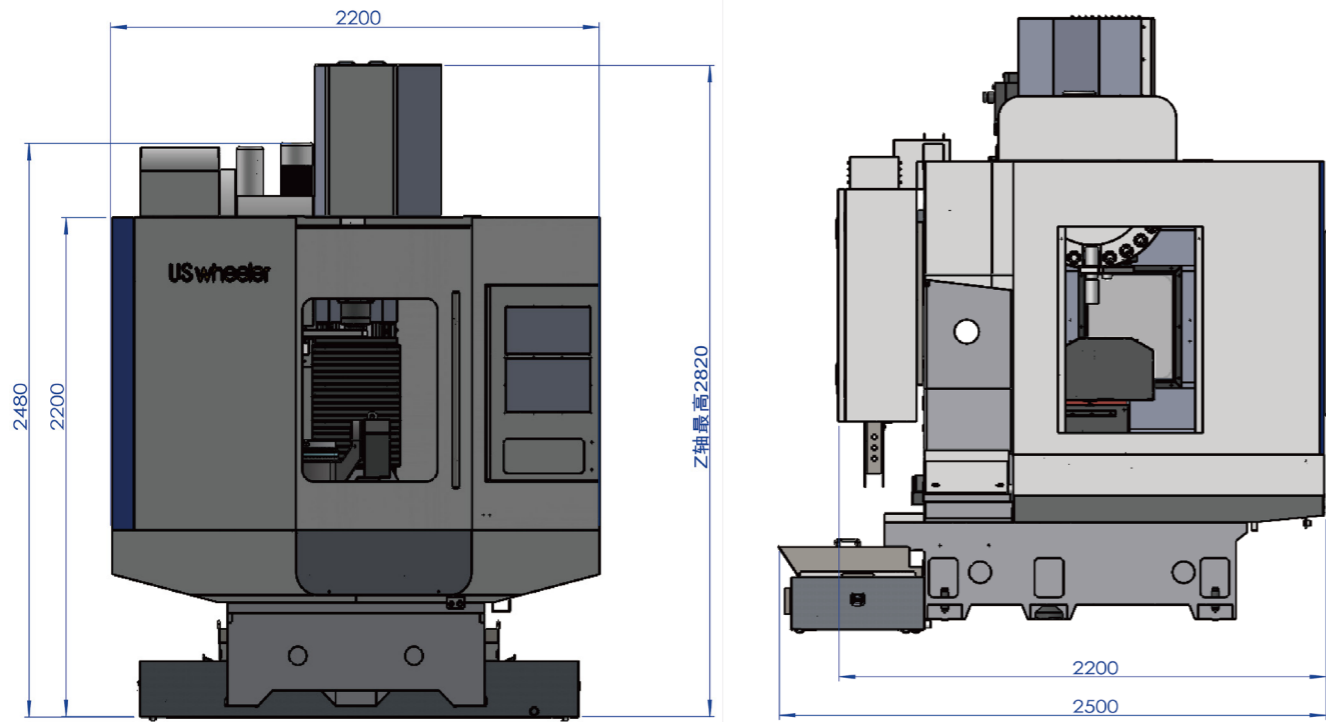

+ EU5-700

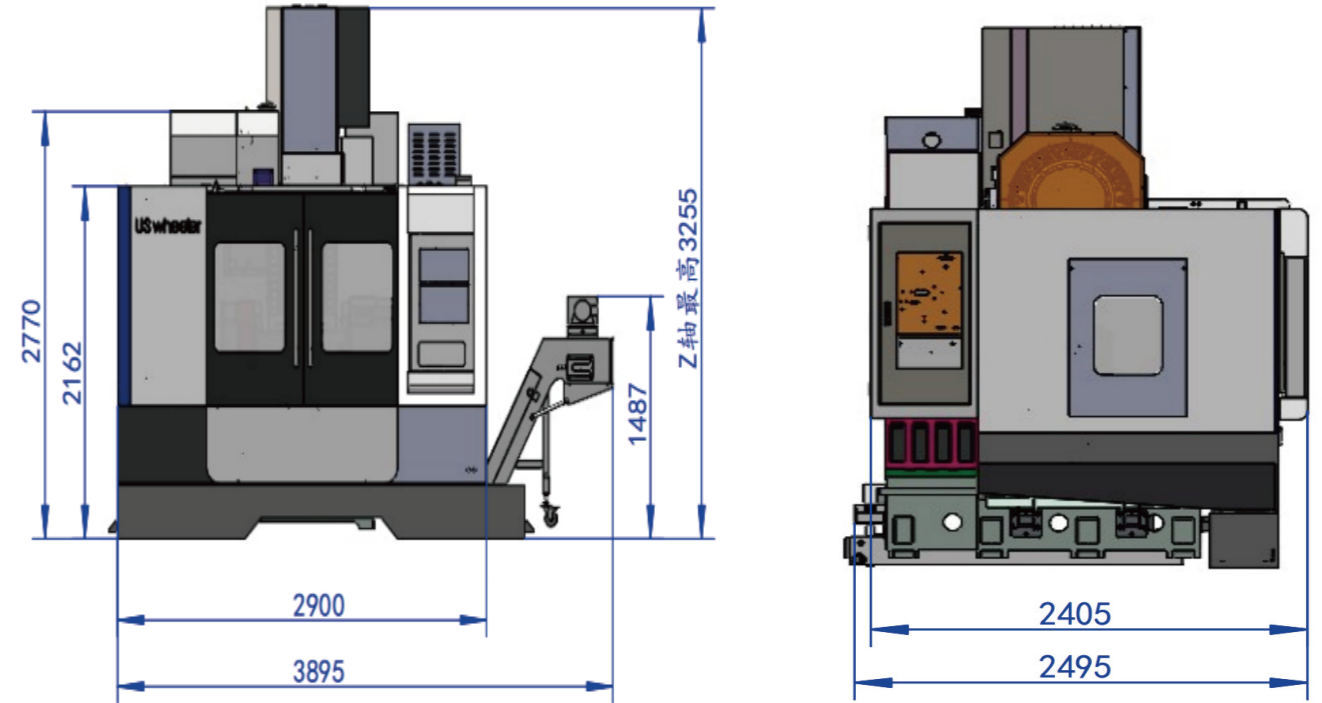

+ EU5-650

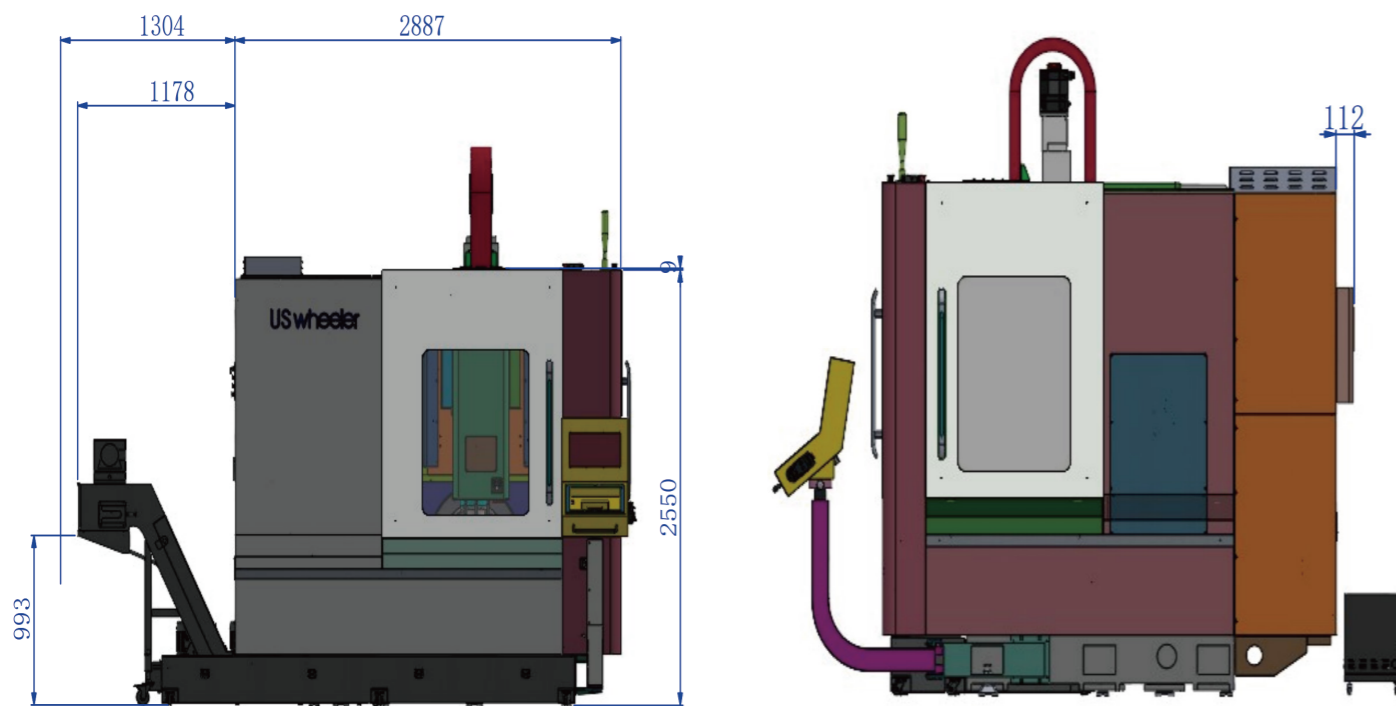

+ EU5-800

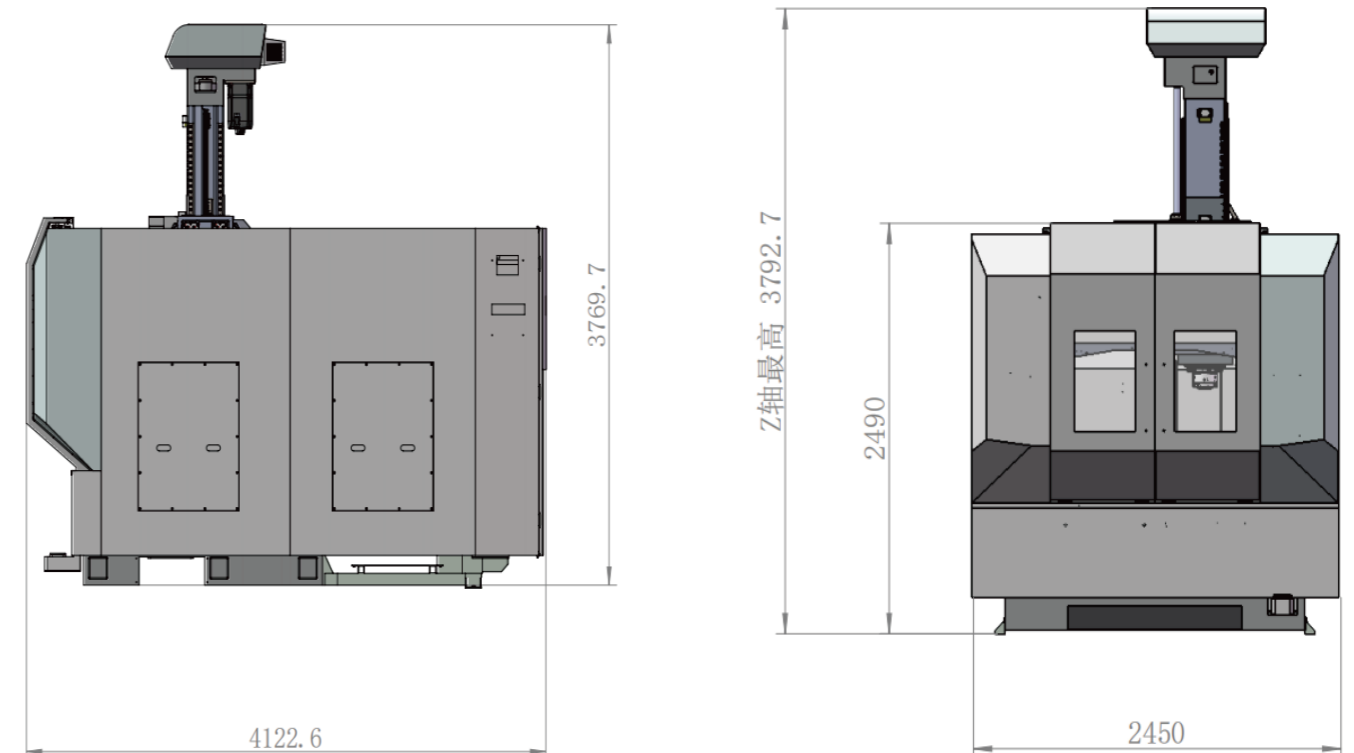

STANDARD CONFIGURATION

+ EU5-380



- SYNTEC 220MA Controller
- 10.4 inch LCD Colorful Screen
- CNC Five-axis Rotary Table
- 3 Color Warning Light
- Full Cover Sheet Metal
- MPG
- LED Working Light
- Transformer
- Ethernet Interface, CF Card Slot
- Safe Door Switch
- Heat Exchanger in Electric Cabinet

+ EU5-700



- Fanuc 0IMF Plus Controller
- 10.4 inch LCD Colorful Screen
- CNC Five-axis Rotary Table
- 3 Color Warning Light
- Full Cover Sheet Metal
- MPG
- LED Working Light
- Transformer
- Ethernet Interface, CF Card Slot
- Safe Door Switch
- Heat Exchanger in Electric Cabinet

+ EU5-650

- Fanuc 0IMF Plus Controller
- 10.4 inch LCD Colorful Screen
- CNC Five-axis Rotary Table
- 3 Color Warning Light
- Full Cover Sheet Metal
- MPG
- LED Working Light
- Transformer
- Ethernet Interface, CF Card Slot
- safe Door Switch
- Heat Exchanger in Electric Cabinet



+ EU5-800



- SINUMERIK ONE Controller
- 22 inch TFT Touch Screen Display
- 40T Tool Magazine
- Centralized Oil Lubrication Device
- CNC Five-axis Rotary Table
- Full Cover Sheet Metal
- LED Working Light
- Cutting Fluid Coolant Device
- Ethernet Interface
- CF Card Slot
- Anchor Bolts and Blocks

DETAILED INFORMATION

		EJ5-380	EJ5-650	EJ5-700	EJ5-800
Processing Capacity	X axis Travel(mm)	500	820	750	800
	Y axis Travel(mm)	510	520	600	1100
	Z axis Trave(mm)	450	500	600	600
	Caxis °	360°	360°	360°	360°
	A/B axis Travel °	A axis±120°	B axis±110°	A axis+30°~-120°	A axis±120°
	Distance from Spindle surface to Table ((mm)	37-487	150-650	120-720	168-768
Rotary Table	Table Size(mm)	Φ260	Φ650	Φ410	Φ800
	Max. Rotate Dia. (mm)	Φ400	Φ650	Φ620	Φ1000
	Center Hole Dia. (mm)	Φ46H7	Φ55H7	Φ50H7	Φ155H7
	Max. Load(Kg)	60	300	200	1000
	T Slot Size(mm)	12H7	18H7	12H7	14H7
Spindle	Drive Type	Direct drive	Direct drive	Direct drive	Motorized drive
	Max. Speed(rpm)	12000	12000	12000	15000
Main Motor	Power (kW)	7.5	11/15	11/15	30/46
	Max. Torque(Nm)	71.7	118	118	200
	Spindle Taper	BT-40	BT-40	BT-40	HSK A63
Servo Axis	X/Y/Z Rapid Traverse(m/min)	36/36/36	36/36/36	36/36/36	50/50/50
	X/Y/Z Servo Motor Drive	Direct Drive	Direct Drive	Direct Drive	Direct Drive
	X/Y/Z Servo Motor Speed	3000/3000/3000	3000/3000/3000	3000/3000/3000	3000/3000/3000
	X/Y/Z axis Lead Screw Pitch	12/12/12	12/12/12	12/12/12	20/20/20
	X/Y/Z axis Lead Screw Dia	Φ28/Φ28/Φ32	Φ40/Φ40/Φ40	Φ40/Φ40/Φ40	Φ40/Φ40/Φ40
	Cutting Feedrate(mm/min)	1-10000	1-10000	1-10000	1-30000
	Min. Feed(mm)	0.001	0.001	0.001	0.001
Guideway Type	X/Y/Z	Linear	Linear	Linear	Linear
A/B/C Axis	Max. Speed(rpm)	A/C axis 60/386	B/C axis 25/25	A/C axis 12.5/20	A/C axis 50/80
	Min. Input Unit °	0.001°	0.001°	0.001°	0.001°
	Max. Torque A/C(Nm)	460/223	35/15	550	5000/2500
Others	Temperature (°C)	0°C~+40°C	0°C~+40°C	0°C~+40°C	0°C~+40°C
	Capacity(kVA)	30	30	30	100
	Lubrication Fluid Capacity(L)	3	3	4	3
	Cutting Fluid Capacity(L)	300	300	286	500
	Air Pressure(Bar)	6~8	6~8	6~8	6~8
Dimension	L*W*H(mm)	2200*2400*2900	3150*2920*3200	2900*2400*3000	5400*4500*3300
Weight (KG)		4000	12500	8000	15000
Controller		SYNTEC	SYNTEC/FANUC/SIEMENS	SYNTEC/FANUC/SIEMENS	SIEMENS

